



Delaware River
Joint Toll Bridge
Commission

STAGING

MAINTENANCE & PROTECTION OF TRAFFIC

Eastbound Traffic Detoured July – September 2024

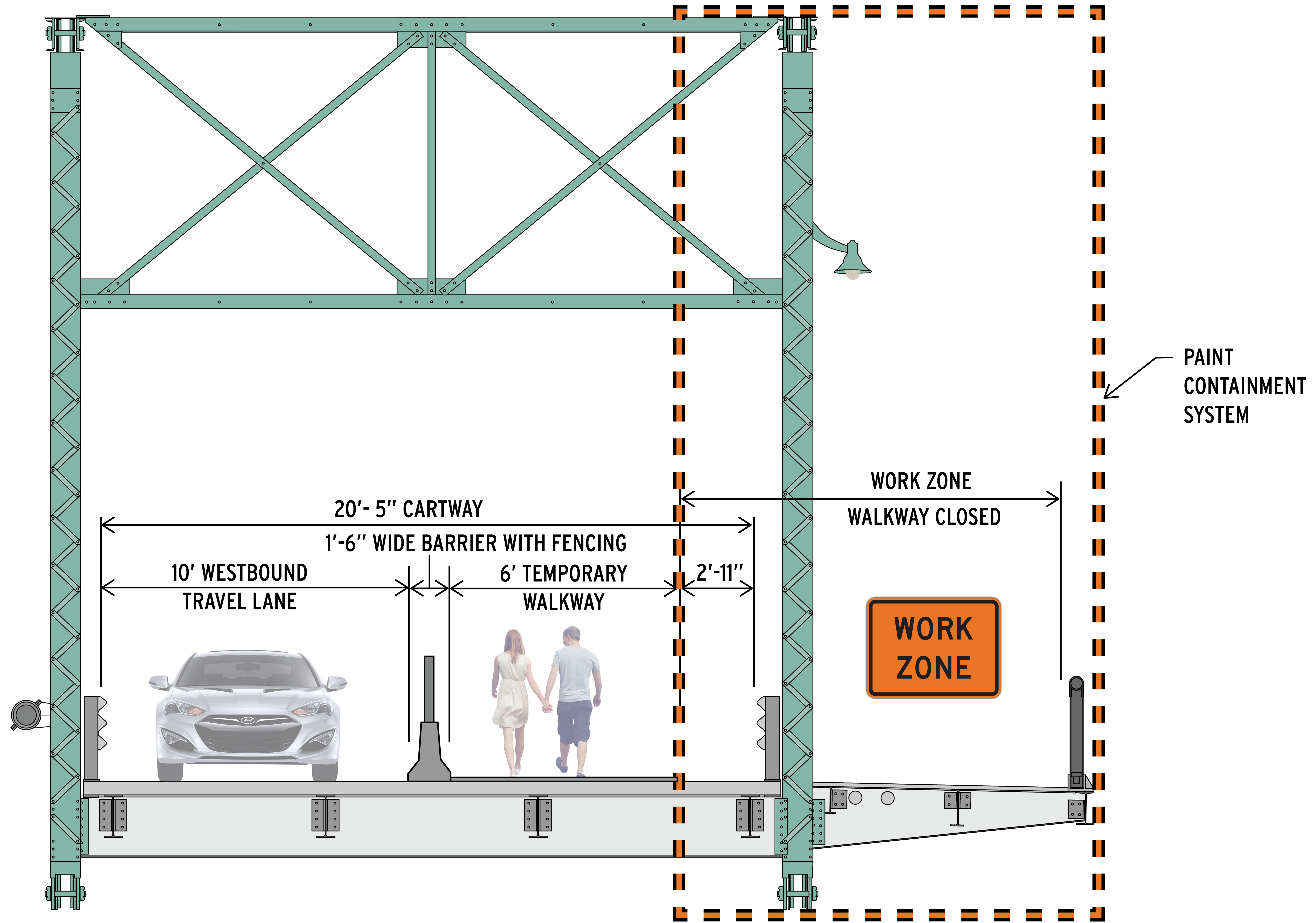

STAGE 3 - PORTION OF BRIDGE CLOSED
(LOOKING EAST)

NEW HOPE - LAMBERTVILLE TOLL-SUPPORTED BRIDGE REHABILITATION

Borough of New Hope, PA & City of Lambertville, NJ | Contract C-694A, Capital Project 1430A

Scan For Project
Information

